

# 299

## THOMAS E. DUNN MEMORIAL HIGHWAY RUTHERFORD, NJ



### **PRIME MEADOWLANDS WAREHOUSE/DISTRIBUTION FACILITY IMMEDIATE ACCESS TO/FROM: I95/NJ TURNPIKE (EXIT 16W), RT. 3 & RT. 17**

<b>BUILDING SIZE:</b>	<b>404,000 square feet</b>
<b>PROPERTY:</b>	<b>25.5 acres – Block 219.02 Lot 79</b>
<b>ZONING:</b>	<b>Zone B – Light Industrial &amp; Distribution</b>
<b>LOADING DOCKS:</b>	<b>40 docks (includes 23 interior bays) w/new doors &amp; levelers</b>
<b>DRIVE IN:</b>	<b>1 ramp</b>
<b>OFFICE AREAS:</b>	<b>20,585 sq. ft., 7,714 sq. ft., 2,494 sq. ft. &amp; 1,403 sq. ft.</b>
<b>CLEAR HEIGHT:</b>	<b>25 feet</b>
<b>HVAC:</b>	<b>Warehouse: New rooftop gas heating air handler units Office: New rooftop package HVAC units</b>
<b>GAS SERVICE</b>	<b>Pipeline quality w/ 120 psig</b>
<b>SPRINKLER:</b>	<b>Wet system with .6 gpm / 3000 sf density</b>
<b>PARKING:</b>	<b>315 spaces</b>
<b>COLUMNS:</b>	<b>48' x 30'</b>
<b>POWER:</b>	<b>Services of 2000, 1200 &amp; 600 amps</b>
<b>RAIL SIDING:</b>	<b>Available</b>
<b>ROOF:</b>	<b>New - installed 2013</b>
<b>FLOOR LOAD:</b>	<b>500 lbs. per sq. ft.</b>
<b>WAREHOUSE LIGHTING:</b>	<b>New T5 energy-efficient fixtures</b>
<b>2013 R.E. TAXES:</b>	<b>\$1.59 per square foot</b>

For more information, please contact:

Brian D. Fitzsimons



374 Millburn Avenue | Millburn, NJ 07041  
973.376.7725 | bfitzsimons@murrayconstruction.com  
www.murrayconstruction.com

No warranty or representation, expressed or implied, is made as to the accuracy of the information contained herein, and same is submitted subject to errors, omissions, change of price, rental or other conditions, withdrawal without notice, and to any special listing conditions.



299

# THOMAS E. DUNN MEMORIAL HIGHWAY RUTHERFORD, NJ

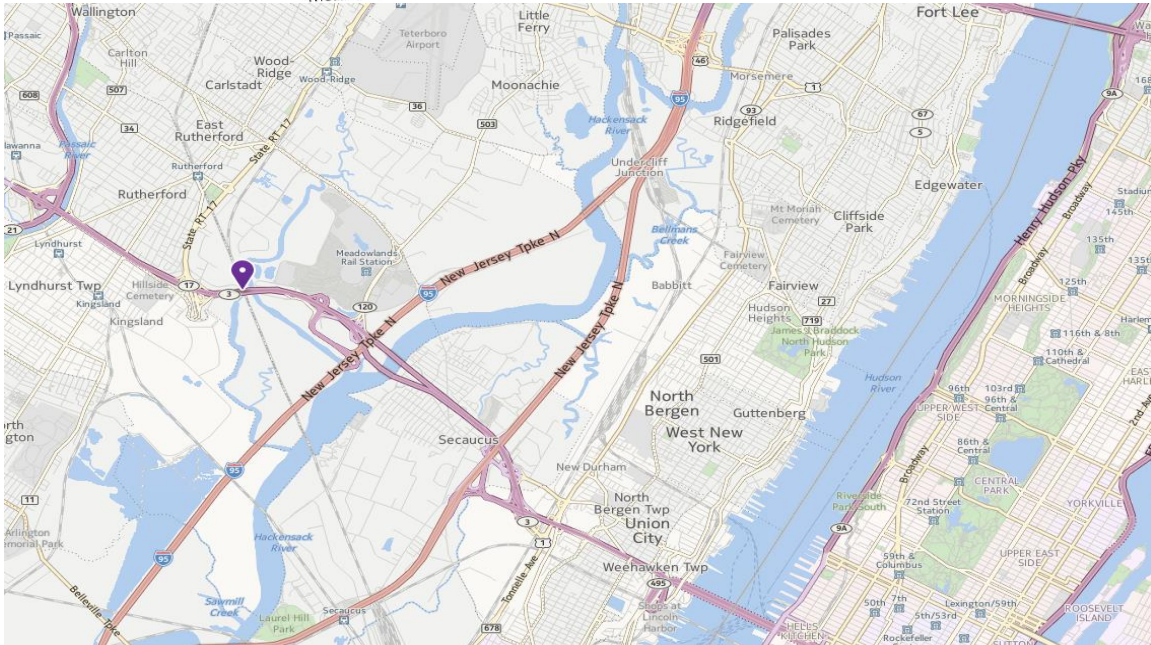
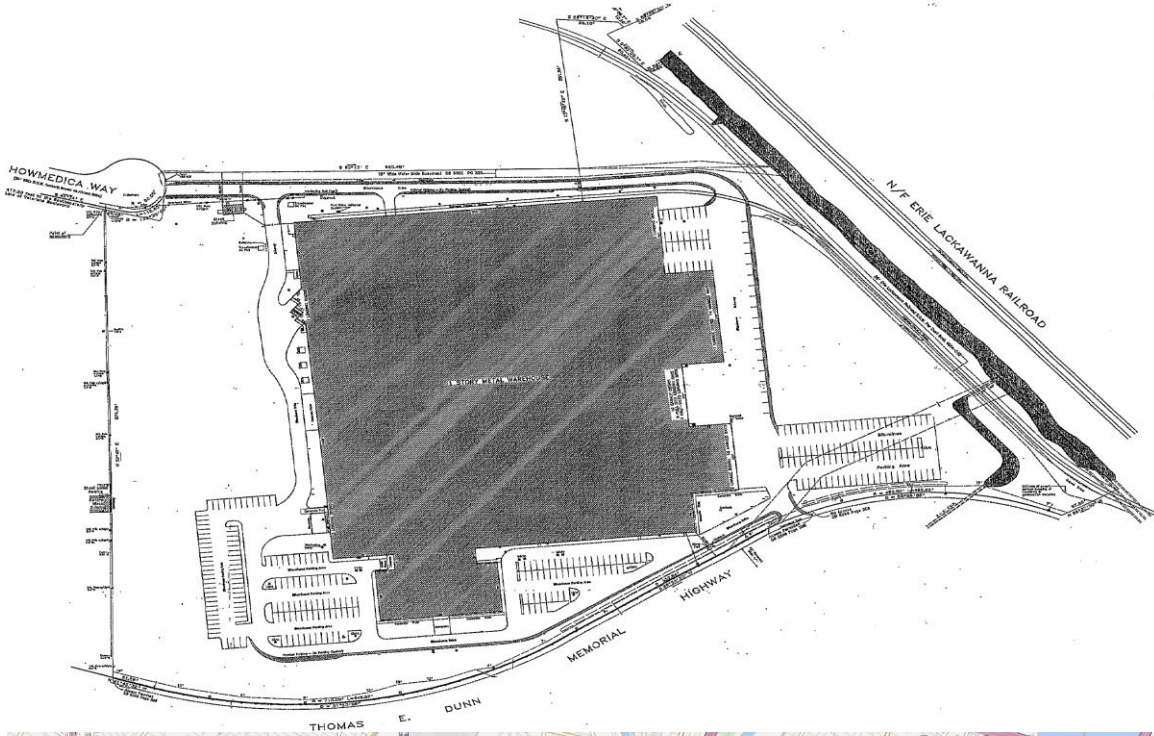

No warranty or representation, expressed or implied, is made as to the accuracy of the information contained herein, and same is submitted subject to errors, omissions, change of price, rental or other conditions, withdrawal without notice, and to any special listing conditions.